

Adopted: 4/03/2019
Effective: 4/13/2019

SNOHOMISH COUNTY COUNCIL
SNOHOMISH COUNTY, WASHINGTON

ORDINANCE NO. 19-011

ADOPTING CHANGES IN VOTING PRECINCTS PURSUANT TO
RCW 29A.16.040, RCW 29A.16.050 AND CHAPTER 2.47 SCC;
AMENDING SCC 2.47

WHEREAS, SCC 2.47.040(2) provides that the County Auditor may temporarily adjust precinct boundaries to maintain conformance with applicable state laws, and that such revisions to voting precincts must be submitted to the County Council for adoption by ordinance no later than May 1 of each year; and

WHEREAS, Exhibit A attached hereto sets forth the precinct changes made by the Auditor since April 4, 2018, including those temporarily adjusted to maintain conformance with applicable state law, resulting in a total of 784 voting precincts in Snohomish County. Exhibit A details 6 changes to precincts due to city annexations and 24 administrative changes to precincts due to growth in the number of voters in a precinct;

NOW, THEREFORE, BE IT ORDAINED:

Section 1. The Council finds that pursuant to the authority of SCC 2.47.040(2), the Auditor made those adjustments to precinct boundaries since April 4, 2018, that are set forth in Exhibit A, attached hereto and incorporated herein by this reference.

Section 2. Snohomish County Code Section 2.47.030, last amended by Amended Ordinance 18-024 on April 4, 2018, is amended to read:

2.47.030 Precincts adopted.

(1) The adopted voting precinct boundaries for the county are those set forth in the precinct map books maintained on file with the clerk of the council and the Snohomish county auditor's office, subject to revision from time to time in accordance with SCC 2.47.040.

(2) To implement boundary changes resulting from redistricting following the federal decennial census and to implement changes that are necessary to maintain conformance with applicable laws in accordance with SCC 2.47.040, the precinct boundaries adopted by subsection (1) are revised cumulatively as set forth in the following documents:

- (a) Exhibit A attached to Ordinance 02-016.
- (b) Exhibit A attached to Ordinance 03-046.

- 1 (c) Exhibit A attached to Ordinance 04-054.
- 2 (d) Exhibit A attached to Ordinance 05-037.
- 3 (e) Exhibit A attached to Ordinance 06-035.
- 4 (f) Exhibit A attached to Ordinance 07-028.
- 5 (g) Exhibit A attached to Ordinance 08-061.
- 6 (h) Exhibit A attached to Ordinance 09-021.
- 7 (i) Exhibit A attached to Ordinance 10-015.
- 8 (j) Exhibit A attached to Ordinance 11-012.
- 9 (k) Exhibit A attached to Ordinance 12-016.
- 10 (l) Exhibit A attached to Ordinance 13- 019.
- 11 (m) Exhibit A attached to Ordinance 14-014.
- 12 (n) Exhibit A attached to Ordinance 15-018.
- 13 (o) Exhibit A attached to Ordinance 16-012.
- 14 (p) Exhibit A attached to Ordinance 17-012.
- 15 (q) Exhibit A attached to Ordinance 18-024.
- 16 (r) Exhibit A attached to Ordinance 19-011.

17
18 Copies of these documents are on file with the clerk of the council and the
19 Snohomish county auditor's office.

20
21 PASSED this 3rd day of April, 2019.

22
23 SNOHOMISH COUNTY COUNCIL
24 Snohomish County, Washington

25
26
27 
28 Council Chair

29 ATTEST:

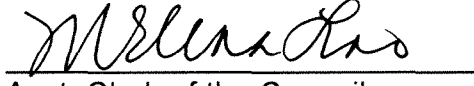
30 
31 _____
32 Asst. Clerk of the Council

- 33
34 APPROVED
35 EMERGENCY
36 VETOED

37 DATE: 4/3/19

38
39 
40 _____
41 County Executive

42 ATTEST:

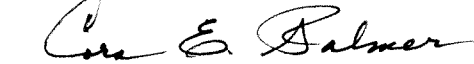
43 
44 _____

1 Approved as to form only:

2  3/5/19
3
4 Deputy Prosecuting Attorney
5
6
7
8
9
10
11
12
13
14
15
16
17
18
19
20
21
22
23
24
25
26
27
28
29
30
31
32
33
34
35
36
37
38
39
40
41
42
43
44
45
46

PRECINCT CHANGES 2019

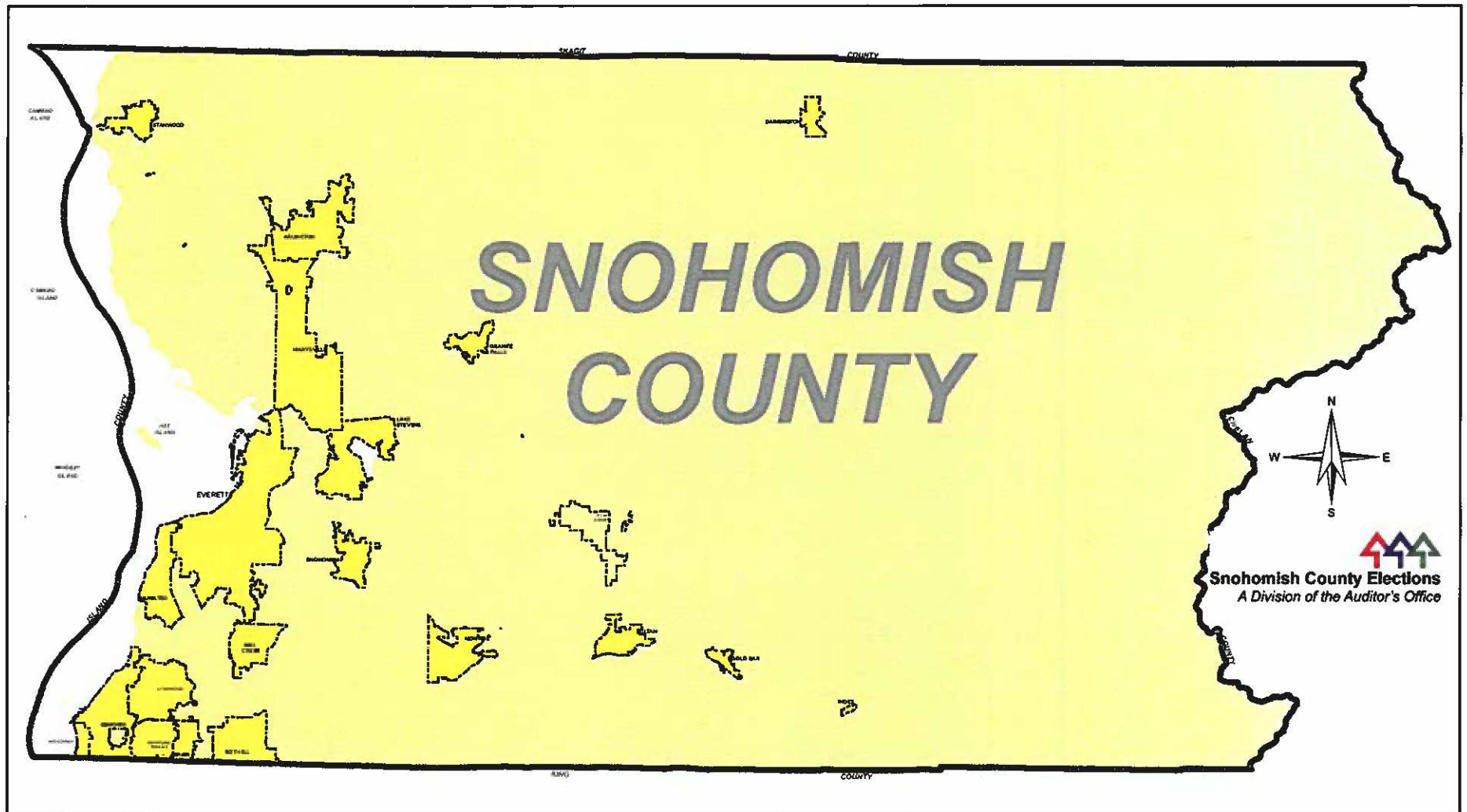

**Snohomish County Auditor
Carolyn Weikel**

Statistics For 2019 Precinct Adjustments

Precincts changed due to annexations	4
Precincts changed due to administrative need	<u>26</u>
Total number of precinct changes	30
New precincts created	7
Precincts dissolved	0
Last year's number of precincts	<u>777</u>
New total number of precincts	784

CONGRESSIONAL DISTRICT PRECINCT COUNT

<u>DISTRICTS</u>	<u>2018</u>	<u>2019</u>	<u>Estimated Voters</u>
CONGRESSIONAL DISTRICT #1	296	300	175,634
CONGRESSIONAL DISTRICT #2	423	426	255,323
CONGRESSIONAL DISTRICT #7	<u>58</u>	<u>58</u>	<u>33,733</u>
Totals	777	784	464,690

LEGISLATIVE DISTRICT PRECINCT COUNT

<u>DISTRICTS</u>	<u>2018</u>	<u>2019</u>	<u>Estimated Voters</u>
LEGISLATIVE DISTRICT #1	109	109	67,282
LEGISLATIVE DISTRICT #10	36	37	21,107
LEGISLATIVE DISTRICT #21	136	137	87,247
LEGISLATIVE DISTRICT #32	72	72	41,782
LEGISLATIVE DISTRICT #38	137	137	79,168
LEGISLATIVE DISTRICT #39	125	127	72,011
LEGISLATIVE DISTRICT #44	<u>162</u>	<u>165</u>	<u>96,093</u>
Total	777	784	464,690

COUNTY COUNCIL DISTRICT PRECINCT COUNT

<u>DISTRICTS</u>	<u>2018</u>	<u>2019</u>	<u>Estimated Voters</u>
COUNCIL DISTRICT #1	165	168	97,292
COUNCIL DISTRICT #2	143	143	81,436
COUNCIL DISTRICT #3	148	149	90,607
COUNCIL DISTRICT #4	152	152	96,672
COUNCIL DISTRICT #5	<u>169</u>	<u>172</u>	<u>98,683</u>
Totals	777	784	464,690

CRITERIA FOR ADJUSTING PRECINCT BOUNDARIES

To identify issues pertaining to precinct boundaries and the functional areas which might be impacted by the population, portions, descriptions and number of voting precincts, various factors have been reviewed. These include:

1. Boundary limitations

Legal requirements mandated by various RCW's require that precinct boundaries do not cross congressional, legislative, judicial, county council or municipal boundaries. These limitations might 'force' the creation of some precincts well below the target size.

2. Number of registered voters

The total number of registered voters per precinct shall not exceed the limit of 1,000 as set by the Snohomish County Council in SCC 2.47.

3. Precincts with school district splits

Since school districts are one of the most active districts having elections within the county, precincts with multiple school districts will be kept to an absolute minimum.

4. Growth potential of area

Growth potential is based on factors such as areas being within Urban Growth Areas and land parcel availability. Growth potential will be a factor in determining how close to the target size each precinct should be.

5. Precincts with multiple district splits

Areas with a large number of portions will be reviewed as to the possibility of reducing district splits within precinct boundaries.

6. Discontinuous precinct portions

Due to city annexations, various precincts have developed parts that are no longer contiguous with the main area of that precinct. These "islands" will be studied for possible merger into adjacent precincts.

7. Use of Census Boundary Standards

In all cases of boundary changes, Census Boundary Standards will be used where possible to designate new precinct lines.

MAP #	PRECINCT NAME	VOTERS BEFORE	TRANSFERRED	VOTERS AFTER	COMMENT
CITY ANNEXATIONS					
	From Pellerin	869	-19	850	Pellerin Annexation
1	To Lake Stevens 24	626	19	645	Ord 1028 Finalized 06/06/2018
	From Winter Lake	334	-5	329	Wyndham Annexation
2	To Sultan 3	781	5	786	Ord 1292-18 Finalized 08/09/2018

ADMINISTRATIVE CHANGES

	From Arlington 13	1019	-155	864	Split due to county limits on the number of registered voters in a precinct
3	To Arlington 16	561	155	716	
	From Granite Falls 2	1032	-257	775	Split due to county limits on the number of registered voters in a precinct
4	To (NEW) Granite Falls 4	0	257	257	
	From Lake Goodwin	1021	-326	695	Split due to county limits on the number of registered voters in a precinct
5	To (NEW) South Lake Goodwin	0	326	326	
	From Marysville 12	1009	-340	669	Split due to county limits on the number of registered voters in a precinct
6	To (NEW) Marysville 61	0	340	340	
	From Everett 18	1020	-87	933	Split due to county limits on the number of registered voters in a precinct
7	To Everett 12	626	87	713	
	From Alder	1060	-197	863	Split due to county limits on the number of registered voters in a precinct
8	To Hipoint	688	197	885	
	From Edmonds 19	1009	-124	885	Split due to county limits on the number of registered voters in a precinct
9	To Edmonds 52	648	124	772	
	From Post	1046	-451	595	Split due to county limits on the number of registered voters in a precinct
10	To (NEW) Arbor	0	451	451	

	From	Mountlake Terrace 3	645	-2	643	Correction to Ord 1340
11	To	Hunt	17	2	19	Ord 1357 Finalized 10/18/1980
	From	Cascadian	1006	-229	777	Split due to county limits on the number
12	To	East Shore	652	229	881	of registered voters in a precinct
	From	Monroe 2	1032	-238	794	Split due to county limits on the number
13	To	(NEW) Monroe 13	0	238	238	of registered voters in a precinct
	From	Overlook	1005	-249	756	Split due to county limits on the number
14	To	(NEW) Fransson	0	249	249	of registered voters in a precinct
	From	Ruggs Lake	1065	-779	286	Split due to county limits on the number
15	To	(NEW) Lakedale	0	779	779	of registered voters in a precinct

WINTER LAKE Annexation to SULTAN 3

(County Council District 5)

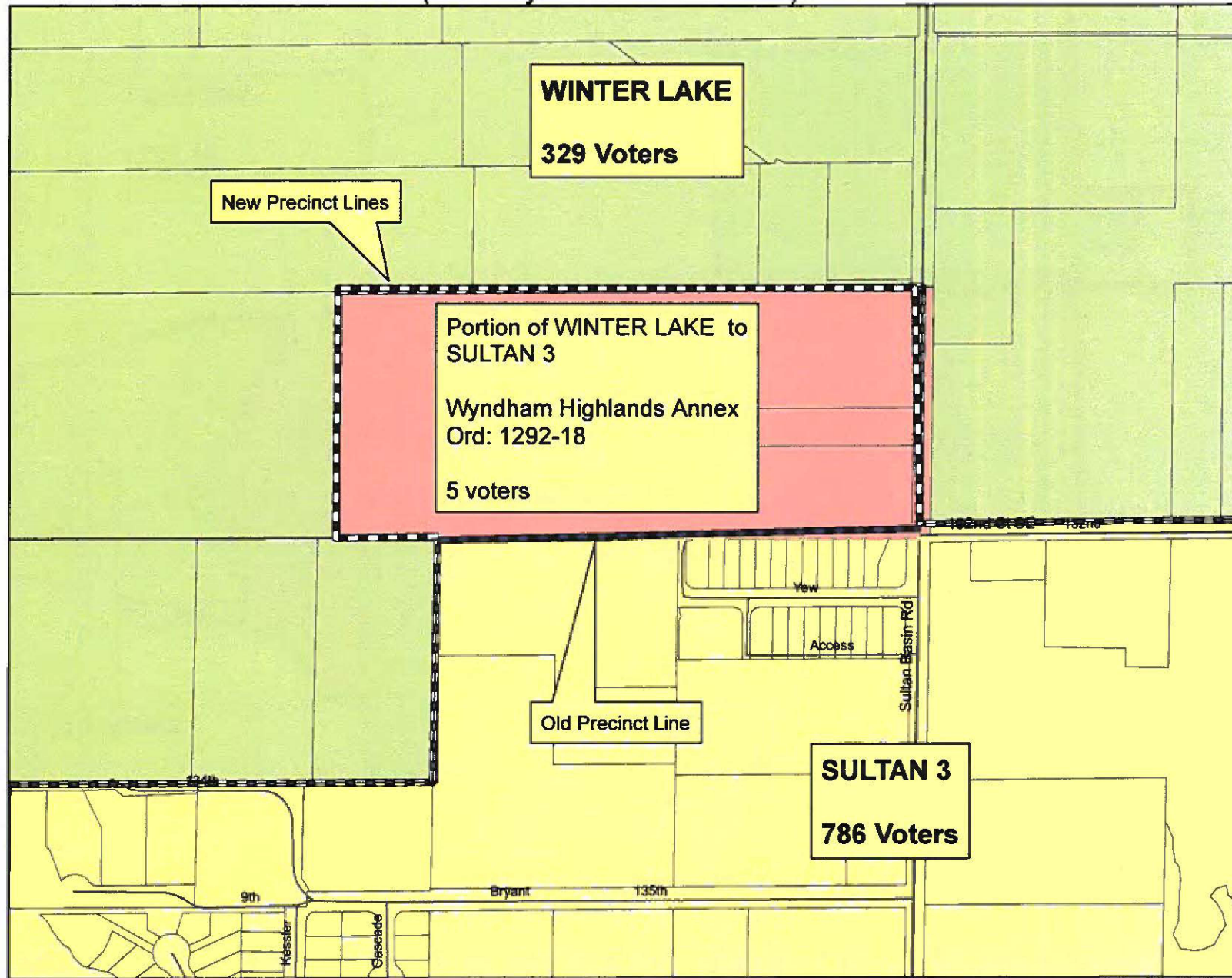

- Legend**
- Streets
 - Precinct Boundary
 - parcels
 - Wyndham Highlands Annex



ARLINGTON 13 to ARLINGTON 16 to reduce voter count

(County Council District 1)

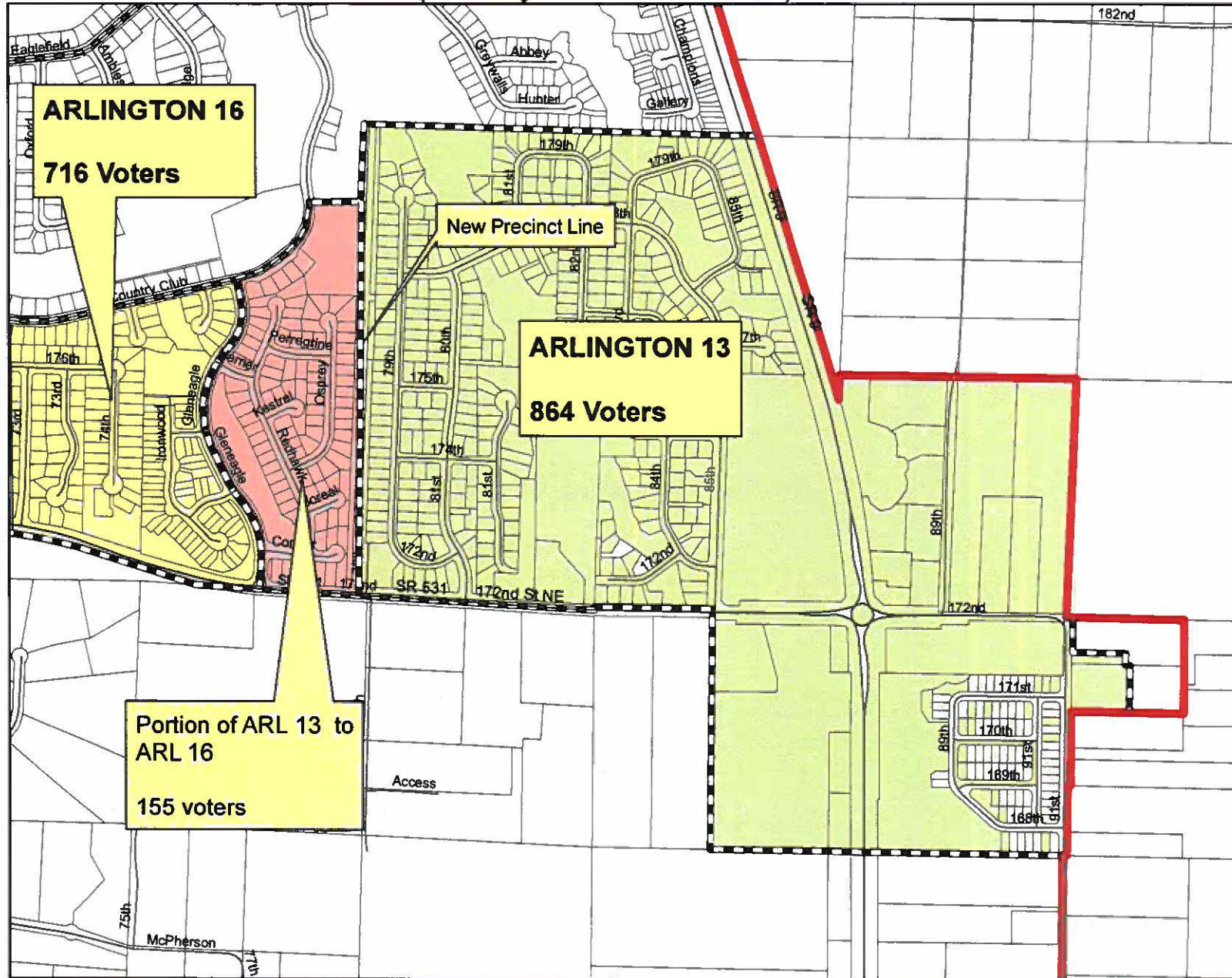

- Legend**
- Streets
 - Congressional District
 - Precinct Boundary
 - parcels





Snohomish County Elections
A Division of the Auditor's Office

3

Map #

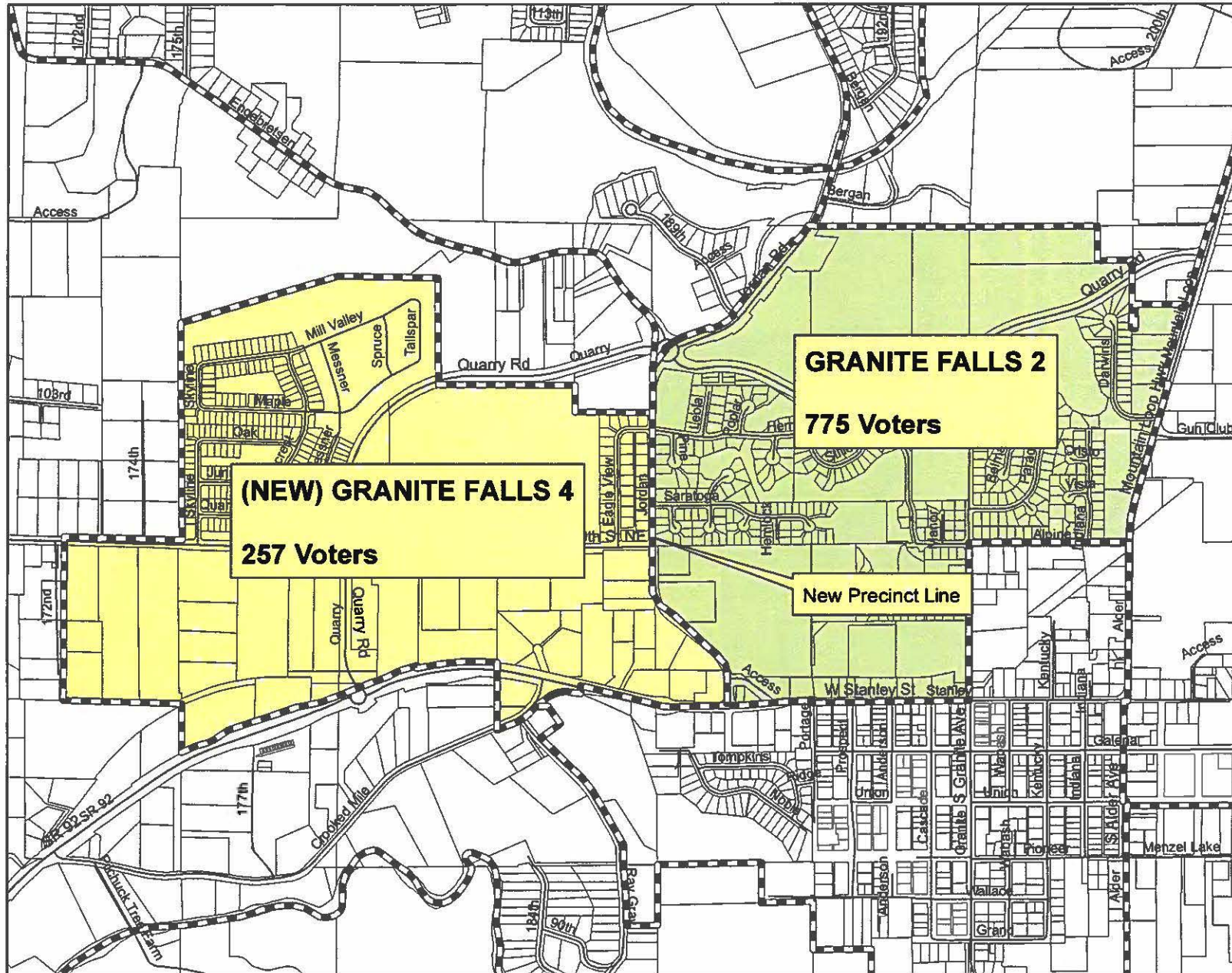
GRANITE FALLS 2 to (NEW) GRANITE FALLS 4 to reduce voter count (County Council District 1)



- Legend**
- Precinct Boundary
 - Streets
 - parcels





Snohomish County Elections
 A Division of the Auditor's Office

4

Map #

LK GOODWIN to (NEW) SO LK GOODWIN to reduce voter count

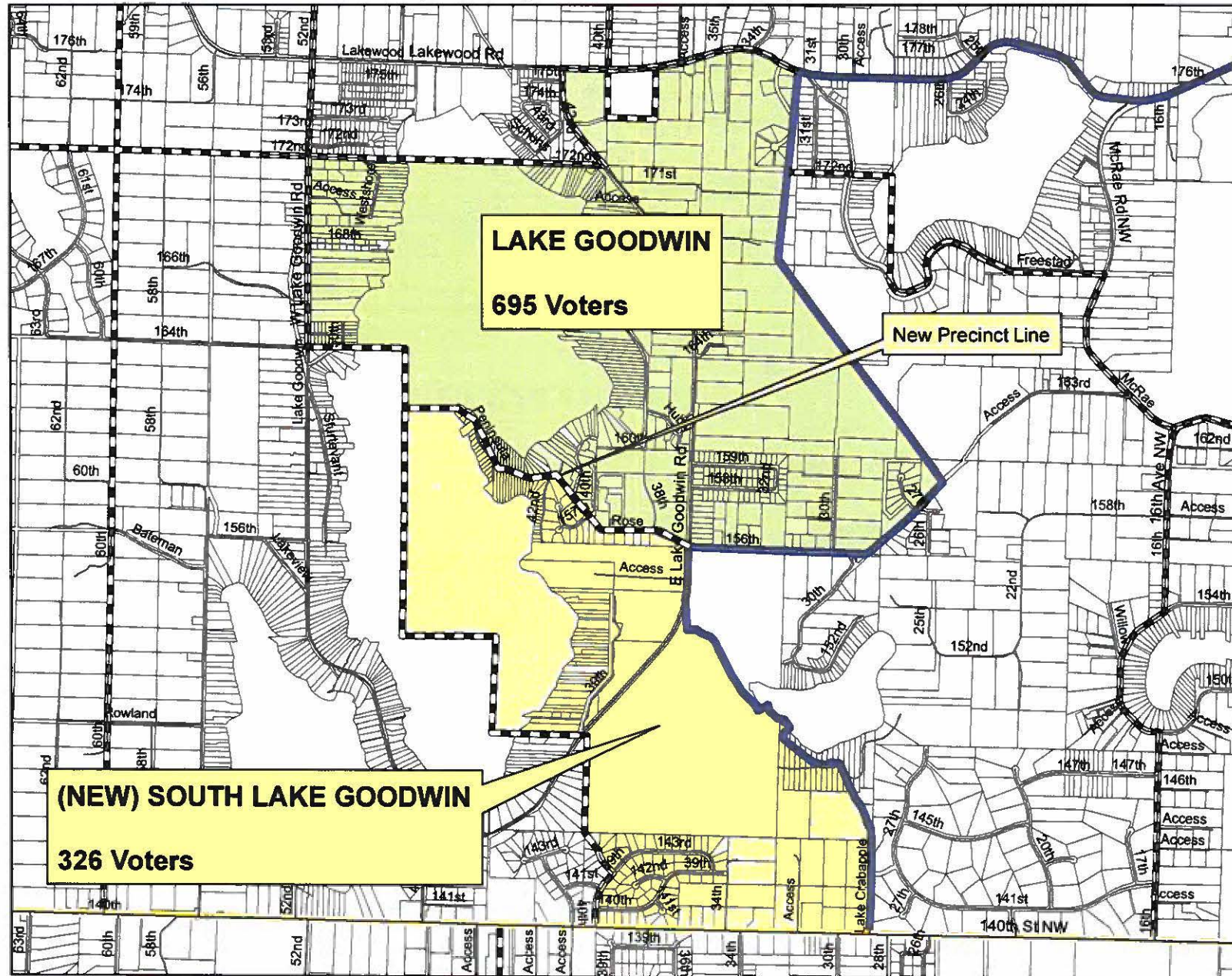
(County Council District 1)



- Legend**
- Streets
 - Justice Court District
 - Council District
 - Legislative District
 - Congressional District
 - Precinct Boundary
 - parcels

Snohomish County Elections
 A Division of the Auditor's Office

5
 Map #

MARYSVILLE 12 to (NEW) MARYSVILLE 61 to reduce voter count (County Council District 1)

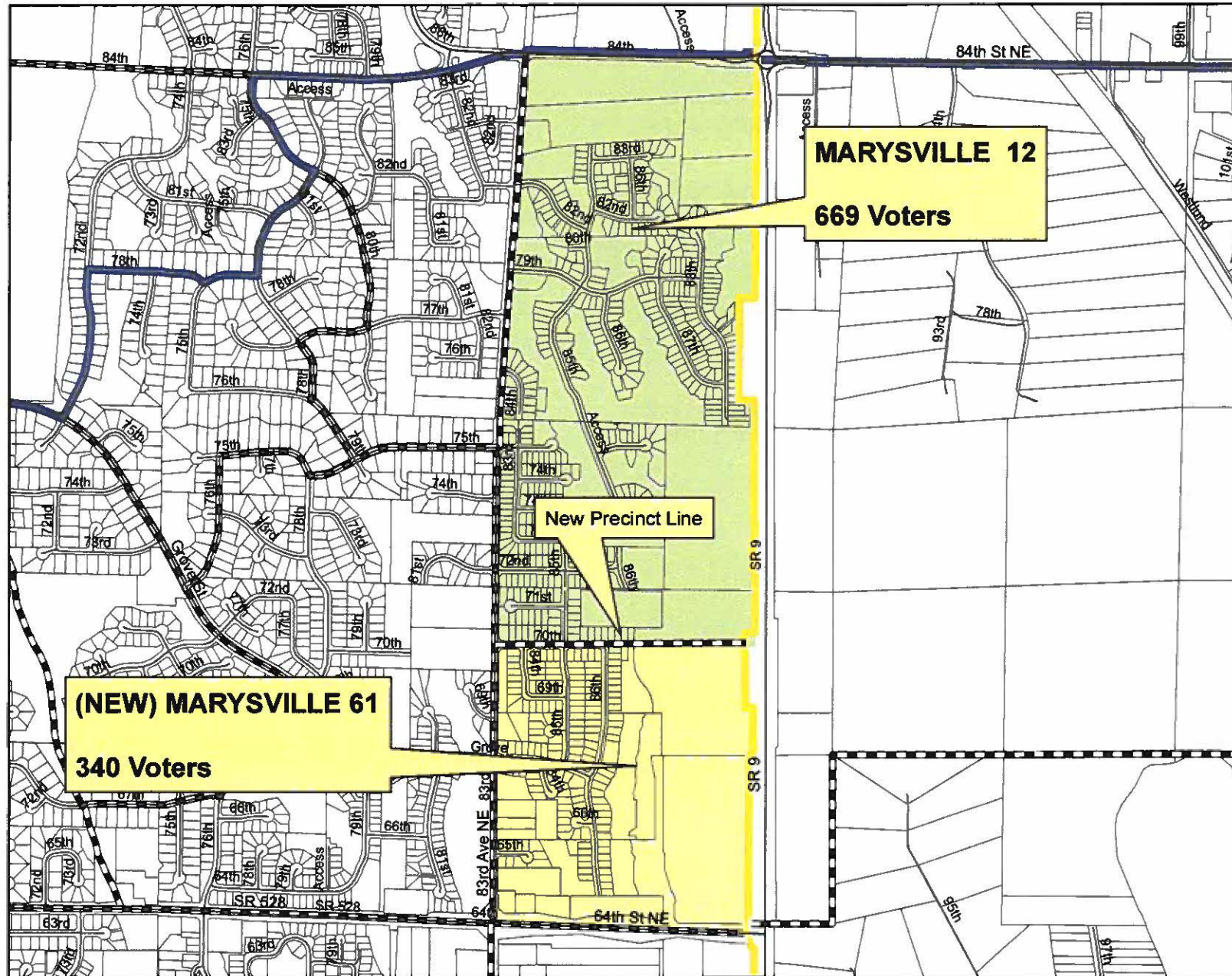

MARYSVILLE 12
669 Voters

(NEW) MARYSVILLE 61
340 Voters

New Precinct Line

- Legend**
- Streets
 - Justice Court District
 - Legislative District
 - Precinct Boundary
 - parcels



Snohomish County Elections
A Division of the Auditor's Office

6

Map #

EVERETT 18 to EVERETT 12 to reduce voter count

(County Council District 2)

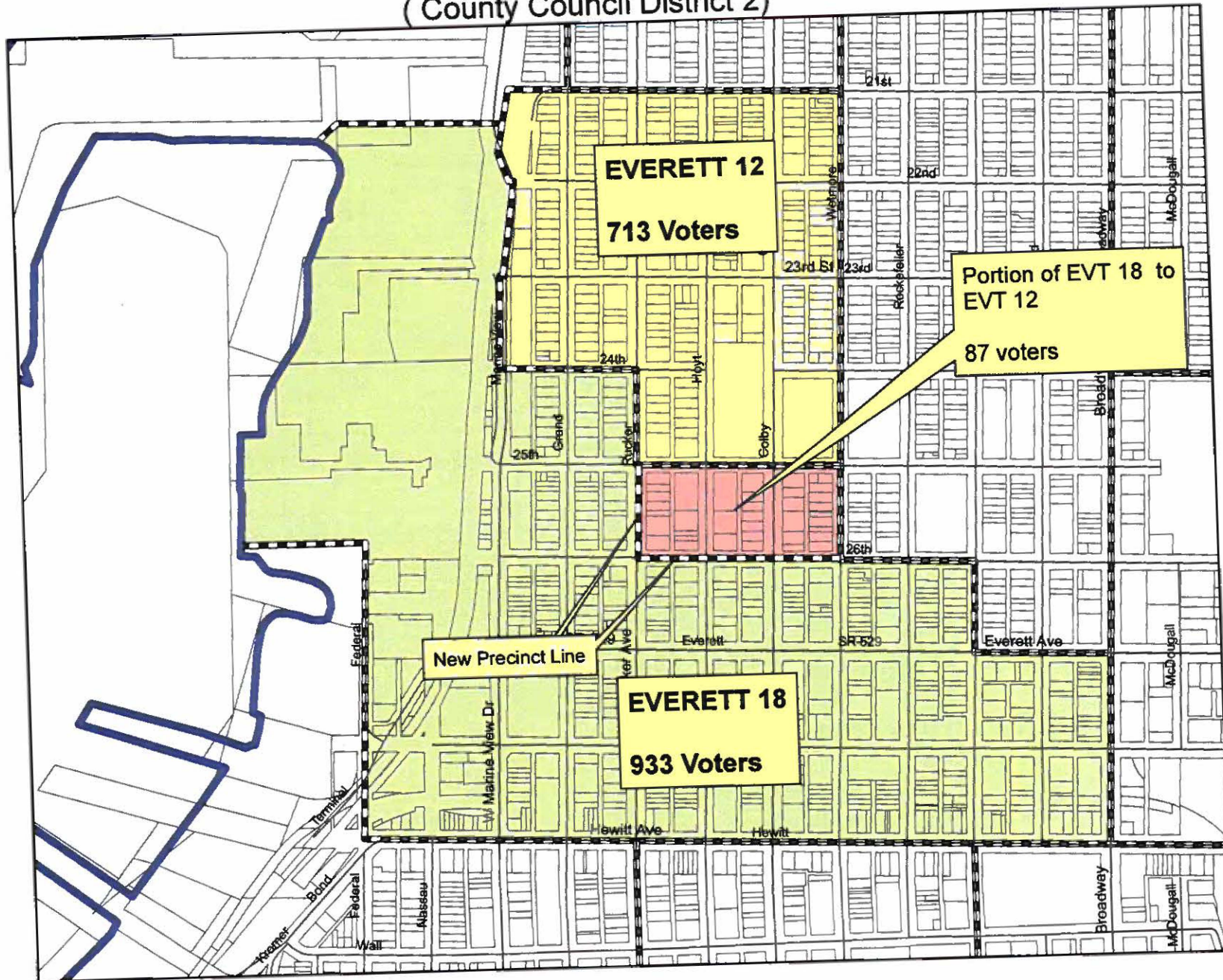

- Legend**
- Streets
 - Legislative District
 - Precinct Boundary
 - parcels





Snohomish County Elections
A Division of the Auditor's Office

7

Map #

ALDER to HIPOINT to reduce voter count

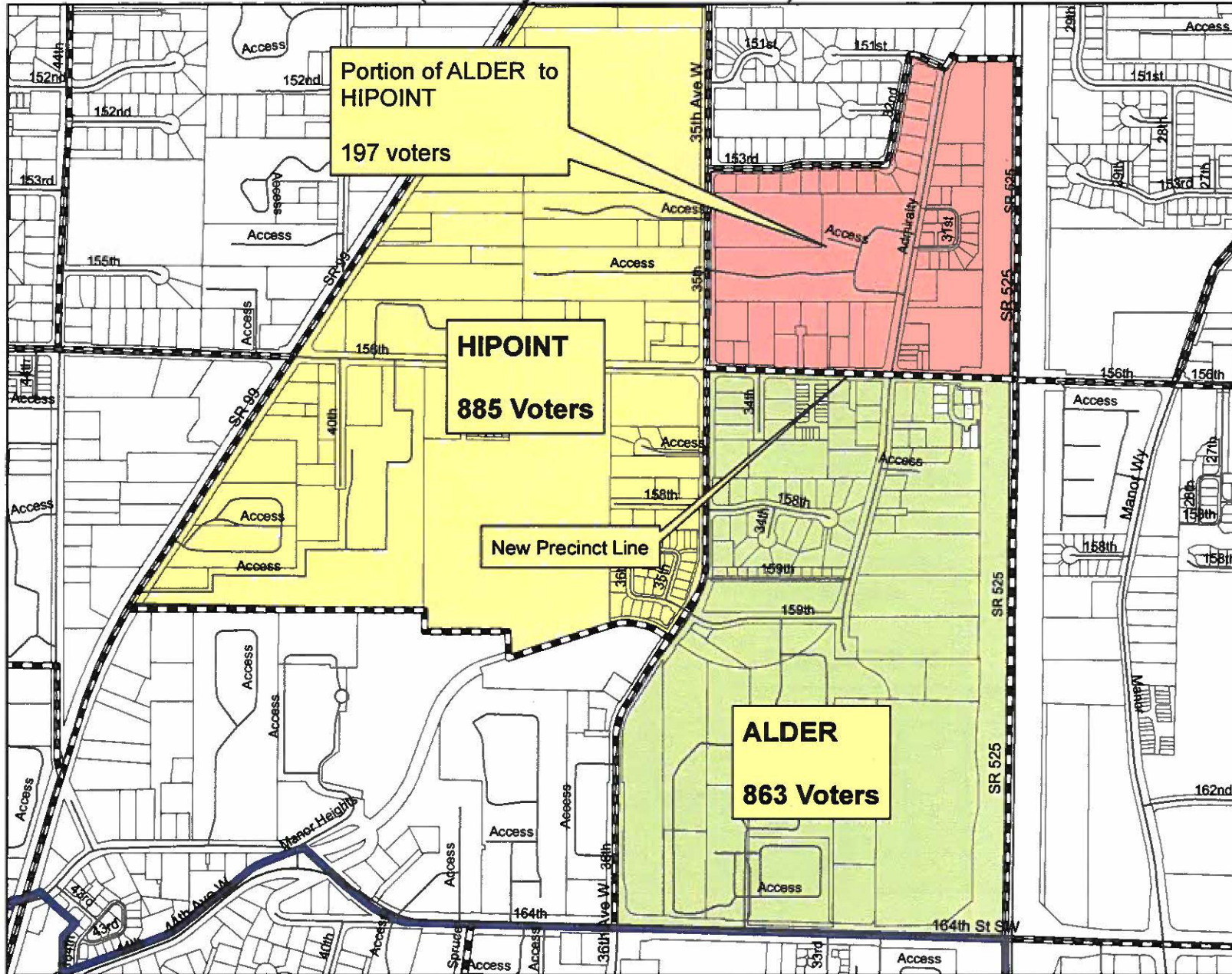
(County Council District 3)



MLT 3 to HUNT Correction (ord 1340: 1357)

(County Council District 4)

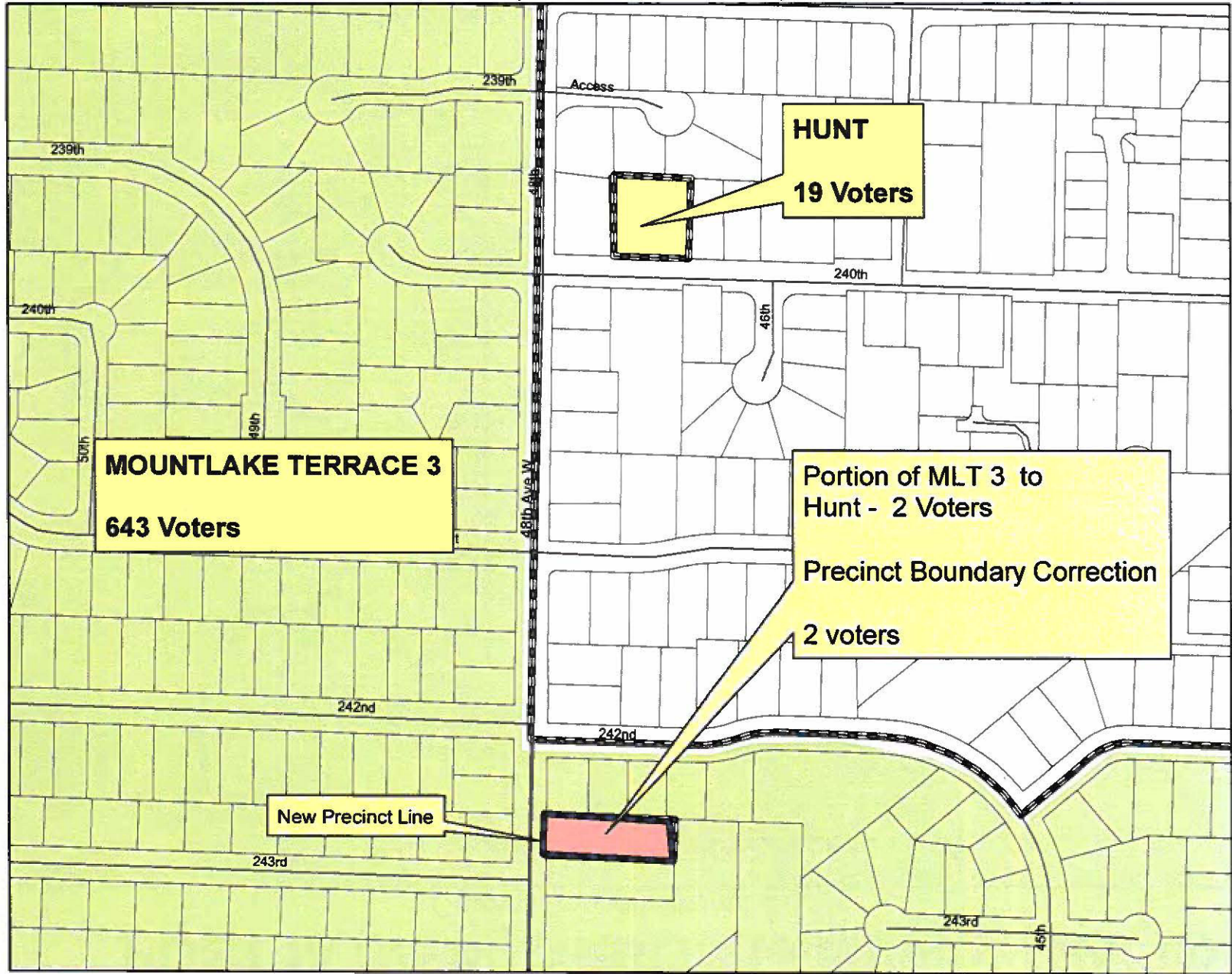

Legend
— Streets
- - - Precinct Boundary
▭ parcels





Snohomish County Elections
A Division of the Auditor's Office

11

Map #

CASCADIAN to EAST SHORE to reduce voter count

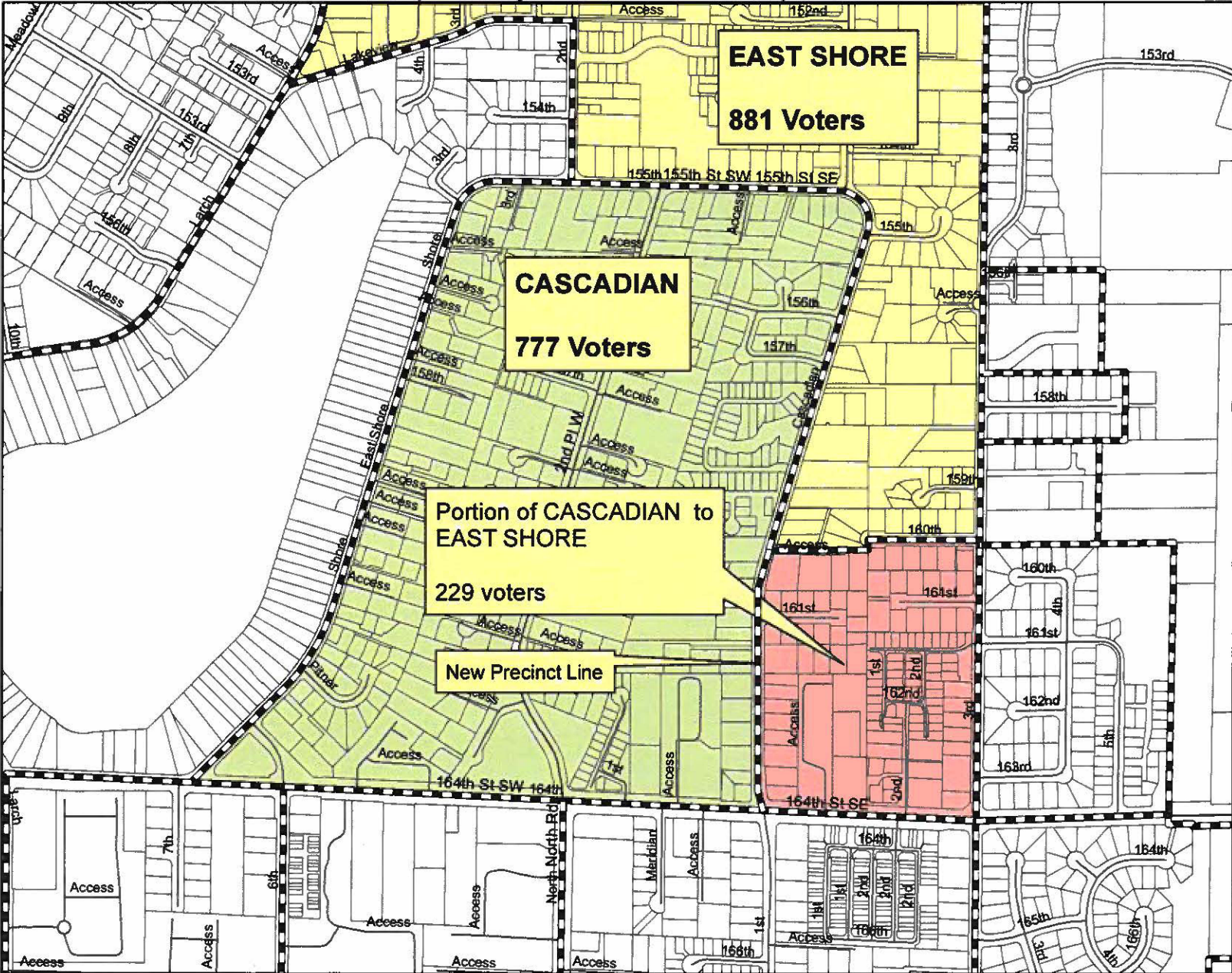
(County Council District 4)



- Legend**
- Precinct Boundary
 - Streets
 - parcels





Snohomish County Elections
A Division of the Auditor's Office

12

Map #

MONROE 2 to (NEW) MONROE 13 to reduce voter count

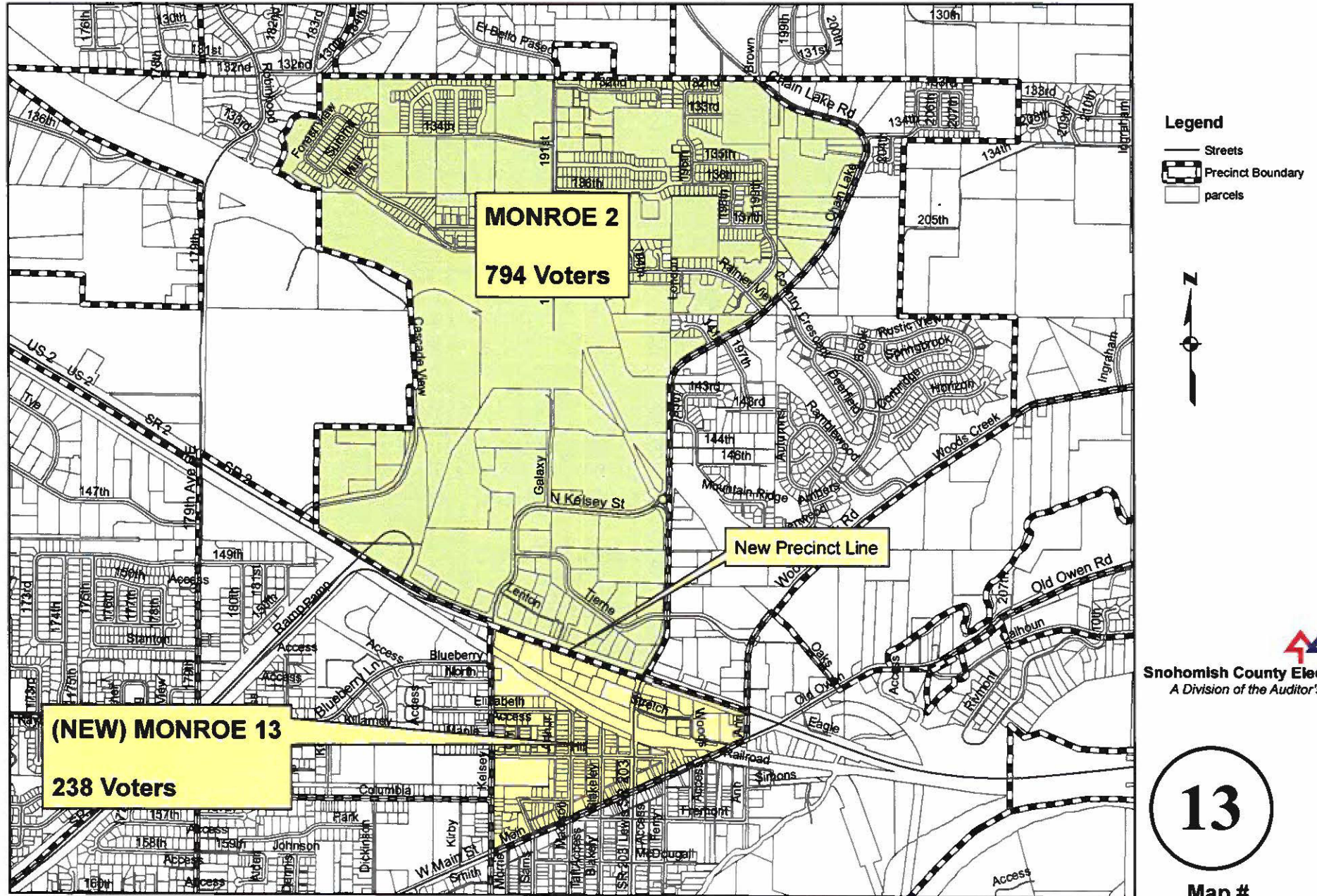
(County Council District 5)



OVERLOOK to (NEW) FRANSSON to reduce voter count (County Council District 5)

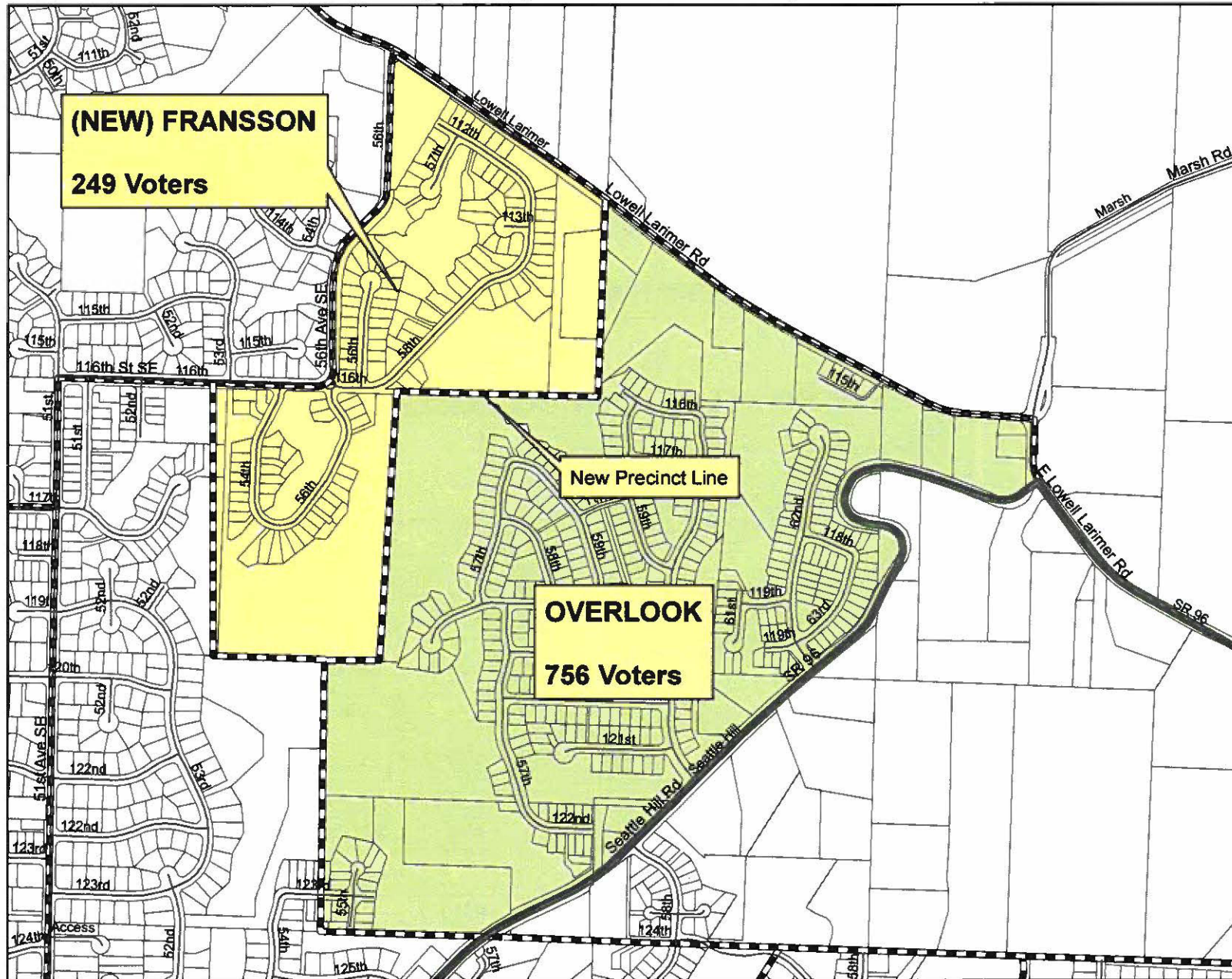

- Legend**
- Streets
 - Council District
 - Precinct Boundary
 - parcels



RUGGS LAKE to (NEW) LAKEDALE to reduce voter count

(County Council District 5)

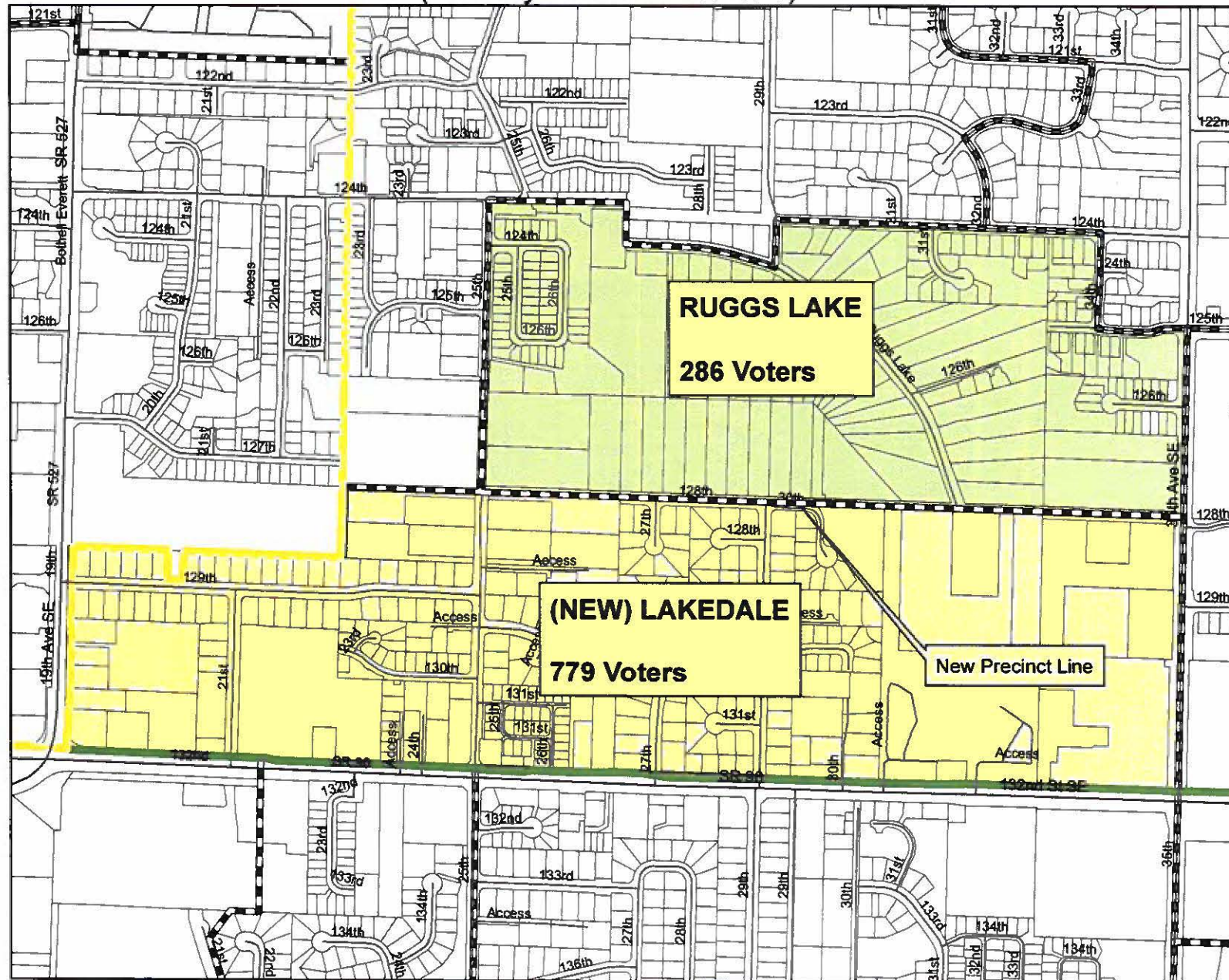

- Legend**
- Streets
 - Justice Court District
 - Council District
 - Precinct Boundary
 - parcels



Snohomish County Elections
 A Division of the Auditor's Office

15
 Map #