

SNOHOMISH COUNTY COUNCIL  
SNOHOMISH COUNTY, WASHINGTON

ORDINANCE NO. 14 - 014

ADOPTING CHANGES IN VOTING PRECINCTS PURSUANT TO  
RCW 29A.16.040, RCW 29A.16.050 AND CHAPTER 2.47 SCC; AMENDING  
CHAPTER 2.47 SNOHOMISH COUNTY CODE

WHEREAS, SCC 2.47.040(2) provides that the County Auditor may temporarily adjust precinct boundaries to maintain conformance with applicable state laws, and that such revisions to voting precincts must be submitted to the County Council for adoption by ordinance no later than May 1 of each year; and

WHEREAS, Exhibit A attached hereto sets forth the precinct changes made by the Auditor since April 24, 2013, including those temporarily adjusted to maintain conformance with applicable state law, resulting in the creation of one new voting precincts for a total of 760 voting precincts in Snohomish County as of April 28, 2014. Exhibit A details 5 changes to precincts due to city annexations and 2 administrative changes due to growth in the number of voters in a precinct and other administrative boundary adjustments;

NOW, THEREFORE, BE IT ORDAINED:

Section 1. The Council finds that pursuant to the authority of SCC 2.47.040(2), the Auditor has made those adjustments to precinct boundaries since April 24, 2013 that are set forth in Exhibit A attached hereto and incorporated herein by this reference.

Section 2. Snohomish County Code Section 2.47.030, last amended by Ordinance 13-019 on April 24, 2013, is amended to read:

**2.47.030 Precincts adopted.**

(1) The adopted voting precinct boundaries for the county are those set forth in the precinct map books maintained on file with the clerk of the council and the Snohomish county auditor's office, subject to revision from time to time in accordance with SCC 2.47.040.

(2) To implement boundary changes resulting from redistricting following the federal decennial census and to implement changes that are necessary to maintain conformance with applicable laws in accordance with SCC 2.47.040, the precinct

boundaries adopted by subsection (1) are revised cumulatively as set forth in the following documents:

- (a) Exhibit A attached to Ordinance 02-016.
- (b) Exhibit A attached to Ordinance 03-046.
- (c) Exhibit A attached to Ordinance 04-054.
- (d) Exhibit A attached to Ordinance 05-037.
- (e) Exhibit A attached to Ordinance 06-035.
- (f) Exhibit A attached to Ordinance 07-028.
- (g) Exhibit A attached to Ordinance 08-061.
- (h) Exhibit A attached to Ordinance 09-021.
- (i) Exhibit A attached to Ordinance 10-015.
- (j) Exhibit A attached to Ordinance 11-012.
- (k) Exhibit A attached to Ordinance 12-016.
- (l) Exhibit A attached to Ordinance 13- 019.
- (m) Exhibit A attached to Ordinance 14- .

Copies of these documents are on file with the clerk of the council and the Snohomish county auditor's office.

PASSED this 16<sup>th</sup> day of April, 2014.

SNOHOMISH COUNTY COUNCIL  
Snohomish County, Washington

  
Chairperson

ATTEST:

  
Clerk of the Council, ASST

- APPROVED
- EMERGENCY
- VETOED

DATE: 4/17/14

  
County Executive

ATTEST:

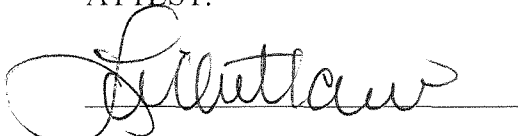
  
Approved as to form only:

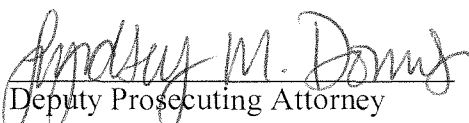
  
Deputy Prosecuting Attorney

Ordinance No. 14- 014  
Adopting Changes to Voting Precincts;  
Amending Chapter 2.47 SCC

D-14

# PRECINCT CHANGES 2014

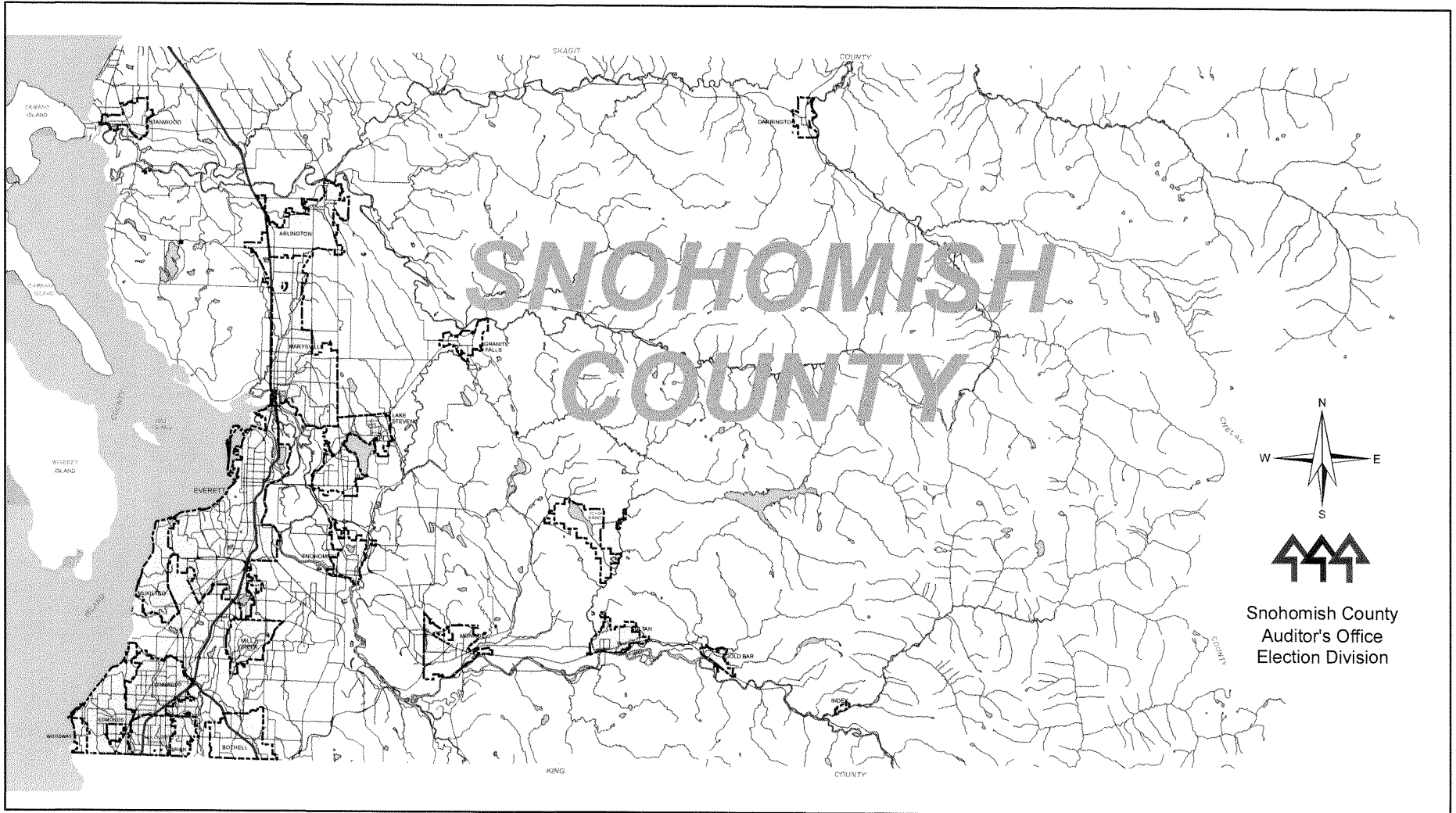

**Snohomish County Auditor  
Carolyn Weikel**

## **Statistics For 2014 Precinct Adjustments**

---

<b>City precincts changed due to annexations</b>	<b>5</b>
<b>Changes due to congressional, legislative, council boundary line changes</b>	<b>0</b>
<b>Changes due to administrative need</b>	<b><u>2</u></b>
<b>Total number of changes</b>	<b>7</b>
<b>New precincts created (not including no registered voters (NRV) precincts)</b>	<b>1</b>
<b>Precincts dissolved</b>	<b>0</b>
<b>Last year's number of precincts</b>	<b><u>759</u></b>
<b>New total number of precincts</b>	<b>760</b>

## CONGRESSIONAL DISTRICT PRECINCT COUNT

<u>DISTRICTS</u>	<u>1/29/2013</u>	<u>1/18/2014</u>	<u>Estimated Voters</u>
CONGRESSIONAL DISTRICT #1	291	292	156,460
CONGRESSIONAL DISTRICT #2	410	410	225,233
CONGRESSIONAL DISTRICT #7	<u>58</u>	<u>58</u>	<u>31,713</u>
Totals	759	760	413,406

## LEGISLATIVE DISTRICT PRECINCT COUNT

<u>DISTRICTS</u>	<u>1/29/2013</u>	<u>1/18/2014</u>	<u>Estimated Voters</u>
LEGISLATIVE DISTRICT #1	104	104	60,744
LEGISLATIVE DISTRICT #10	36	36	18,877
LEGISLATIVE DISTRICT #21	132	132	76,733
LEGISLATIVE DISTRICT #32	71	71	37,734
LEGISLATIVE DISTRICT #38	137	137	70,830
LEGISLATIVE DISTRICT #39	121	122	63,121
LEGISLATIVE DISTRICT #44	<u>158</u>	<u>158</u>	<u>85,367</u>
Total	759	760	413,406

## COUNTY COUNCIL DISTRICT PRECINCT COUNT

<u>DISTRICTS</u>	<u>1/29/2013</u>	<u>1/18/2014</u>	<u>Estimated Voters</u>
COUNCIL DISTRICT #1	159	160	86,098
COUNCIL DISTRICT #2	142	142	73,383
COUNCIL DISTRICT #3	142	142	80,005
COUNCIL DISTRICT #4	148	148	86,679
COUNCIL DISTRICT #5	<u>168</u>	<u>168</u>	<u>87,241</u>
Totals	759	760	413,406

## CRITERIA FOR ADJUSTING PRECINCT BOUNDARIES

To identify issues pertaining to precinct boundaries and the functional areas which might be impacted by the population, portions, descriptions and number of voting precincts, various factors have been reviewed. These include:

1. Boundary limitations

Legal requirements mandated by various RCW's require that precinct boundaries do not cross Congressional, Legislative, Judicial, County Council or Municipal boundaries. These limitations might 'force' the creation of some precincts well below the target size.

2. Number of registered voters

The total number of registered voters per precinct shall not exceed the limit of 1000 as set by the Snohomish County Council in SCC 2.47 (amended 2012).

3. Precincts with school district splits

Since School Districts are one of the most active districts having elections within the county, precincts with multiple school districts will be kept to an absolute minimum.

4. Growth potential of area

Growth potential is based on factors such as areas being within Urban Growth Areas and land parcel availability. Growth potential will be a factor in determining how close to the target size each precinct should be.

5. Precincts with multiple district splits

Areas with a large number of portions will be reviewed as to the possibility of reducing district splits within precinct boundaries.

6. Discontinuous precinct portions

Due to city annexations, various precincts have developed parts that are no longer contiguous with the main area of that precinct. These "islands" will be studied for possible merger into adjacent precincts.

7. Use of Census Boundary Standards

In all cases of boundary changes, Census Boundary Standards will be used where possible to designate new precinct lines.



MAP #	PRECINCT NAME	VOTERS BEFORE	TRANSFERRED	VOTERS AFTER	COMMENT
-------	---------------	---------------	-------------	--------------	---------

**CITY ANNEXATIONS**

1	From	Sexton	652	0	682	Sno Youth Soccer Annexation
	To	<b>Snohomish 5</b>	845	0	837	Ord 2249 - Finalized 3/4/2013
2	From	Burn Hill	582	-4	578	Arlington Country Charm Annexation
	To	<b>Arlington 18</b> (New precinct)	0	4	4	Ord 2014-003 - Finalized 8/28/2013
2	From	Huckelberry	310	0	310	Arlington Country Charm Annexation
	To	<b>Arlington 18</b> (New precinct)	0	0	0	Ord 2014-003 - Finalized 8/28/2013

**ADMINISTRATIVE CHANGES**

3	From	Madison	1008	-122	886	Split due to >1000 voters
	To	<b>Post</b>	583	122	705	

# SEXTON annexation into SNOHOMISH 5

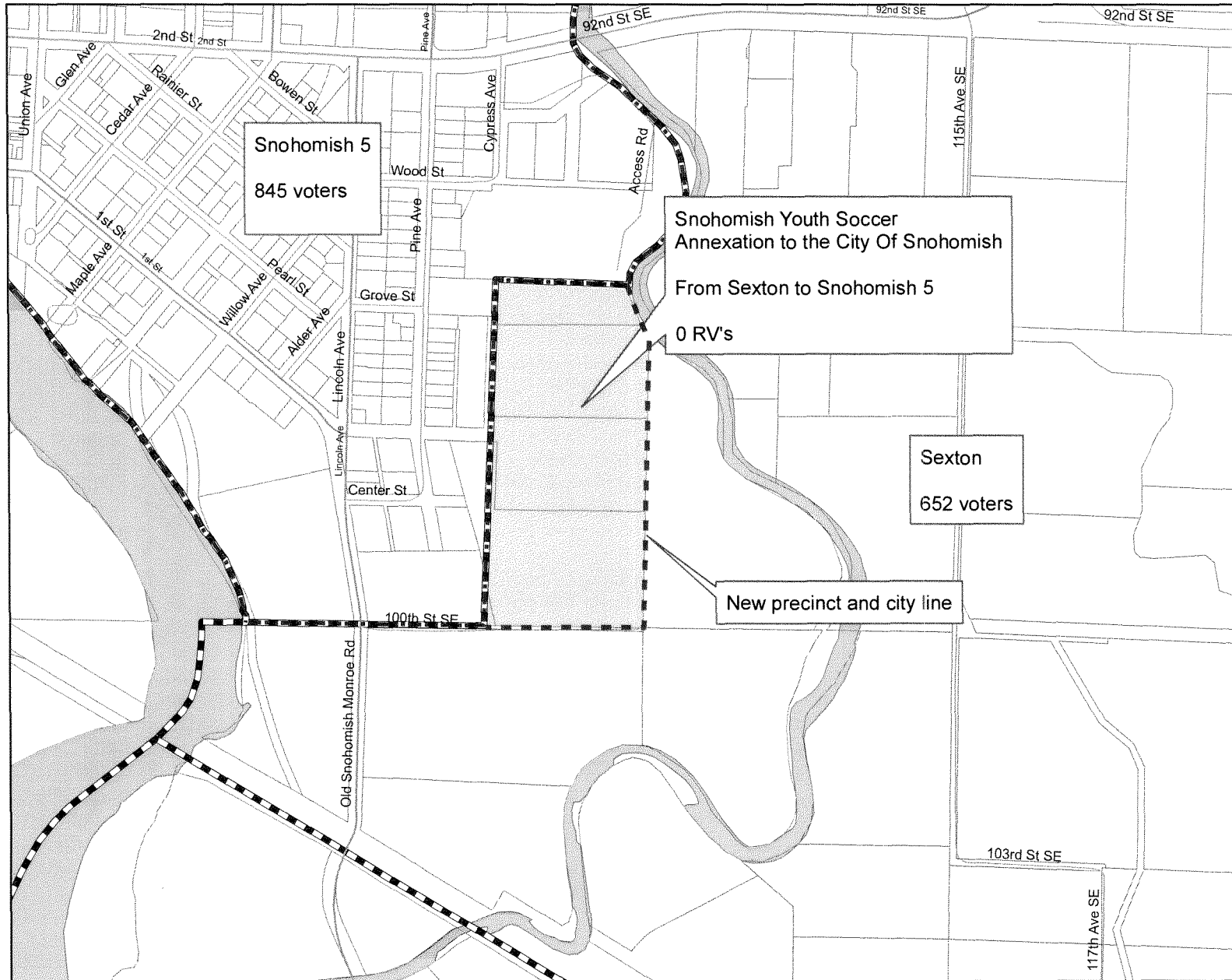

- Legend**
- City Boundary
  - Precinct Boundary
  - Parcels
  - Snohomish Annexation



Snohomish County  
Auditor's Office  
Election Division

1

Map #

# BURN HILL, HUCKLEBERRY annexation to ARL 18

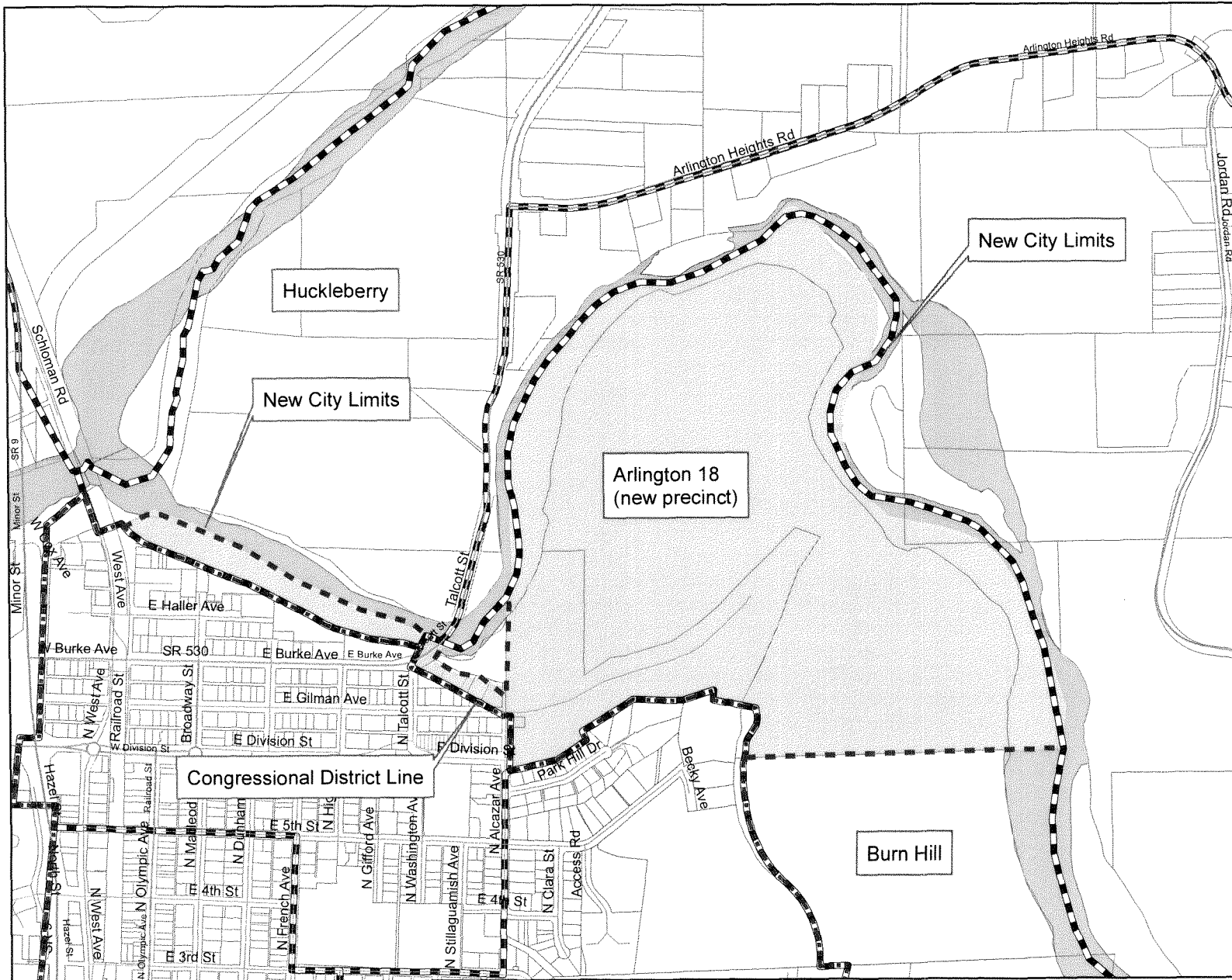

## Legend

- City Boundary
- Precinct Boundary
- ▭ Parcels
- ▨ Country Charm Annexation



Snohomish County  
Auditor's Office  
Election Division



Map #

